



Park View Court, Romiley. SK6 4QH

Located in the heart of Romiley Village in this sought after retirement complex - this first floor two bedroom apartment overlooks the communal gardens and features: Entrance hall, lounge with bay window, modern fitted kitchen with integrated fridge and freezer, 2 bedrooms and modern fitted shower room. There are a wealth of communal facilities including: Resident house manager, communal lounge, guest suite, emergency pull cords, security intercom, well tended gardens and residents car park. Take a look - these apartments always prove extremely popular. EPC rating: C. Leasehold - Annual Ground Rent £291.00 and Annual Service Charge £2487.24 Council Tax Band B.

‘Asking Price’ of £170,000



LIVING ROOM

13' 4" x 10' 10" (4.06m x 3.30m)



BEDROOM TWO

11' 6" x 7' 0" (3.50m x 2.13m)



OUTSIDE



FITTED KITCHEN

11' 4" x 5' 11" (3.45m x 1.80m)



MODERN SHOWER ROOM

7' 10" x 6' 0" (2.39m x 1.83m)



VIEWING ARRANGEMENTS

Appointment is strictly by appointment with Thomas Lardner Romiley Office - telephone number 0161 494 5136.

BEDROOM ONE

11' 7" x 10' 3" (3.53m x 3.12m)



EPC Rating - C
TENURE - LEASEHOLD
Council Tax Band - B

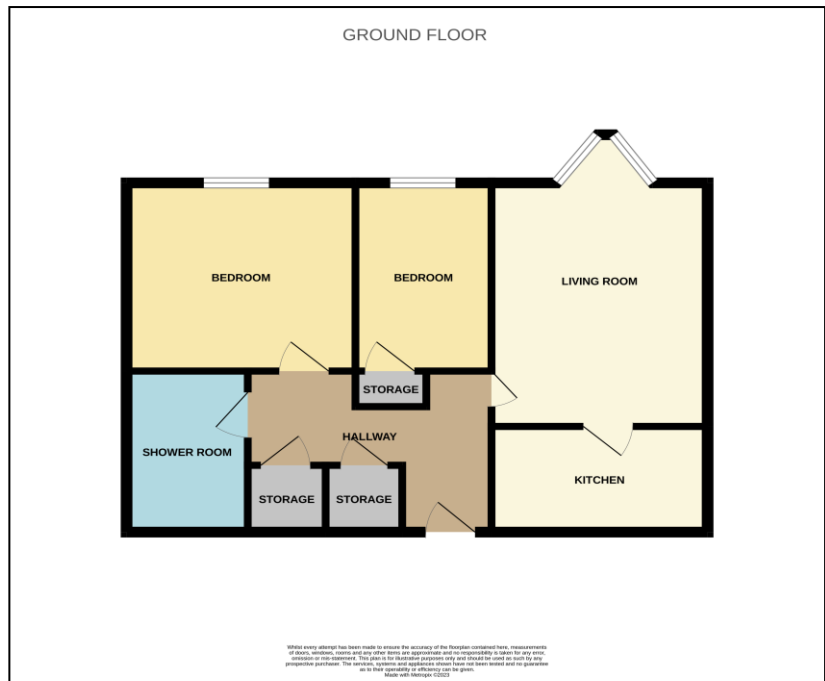

Thomas Lardner Estate Agents, which is a trading name of Stockport Residential Ltd, for themselves and for the vendors or lessors of this property whose agents they are give notice that: (1) all measurements are approximate and any plans provided are not to scale; (2) the particulars are set out as a general outline only for the guidance of intending purchasers or lessors, and do not constitute, nor constitute part of, an offer or contract; (3) we have not tested any apparatus, equipment, fixtures, fittings or services, and so cannot verify that they are in working order or fit for purpose; (4) solicitors should confirm moveable items described in these particulars are, in fact, included in the sale since circumstances change during marketing or negotiations.

T709 Printed by Ravensworth 01670 713330



Thomas Lardner Estate Agents
4 The Precinct, Romiley, Stockport, Cheshire SK6 4EA
0161 494 5136
enquiries@thomaslardner.com
www.thomaslardner.com